

# NONMETALLIC SPUR GEARS • 48 PITCH

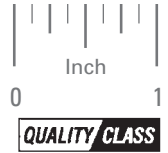

AGMA 8  
1/8 FACE  
20° PRESSURE ANGLE

PHONE: 516.328.3300 • FAX: 516.326.8827 • WWW.SDP-SI.COM



**› MATERIAL:**

**Gear** - Acetal  
**Insert** - Brass

**› SPECIFICATION:**

Gears under 60 teeth have no webs

Gears with:

Bore	Set Screw & Sub Drill
.125	#2-56
.1875	#4-40
.250	#6-32

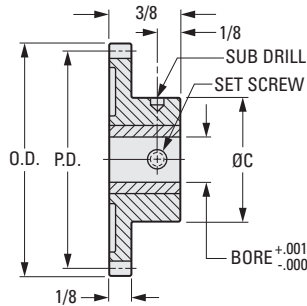

## INCH COMPONENT CATALOG NUMBER

A 1 P 2 - Y 48 □ □ □ □

No. of Teeth Code

**BORE CODE**  
A .125 Dia.  
B .1875 Dia.  
C .250 Dia.

No. of Teeth Code	No. of Teeth	P.D.	O.D.	C Hub Dia.
028	28	.583	.625	33/64
029	29	.604	.646	33/64
030	30	.625	.667	33/64
031	31	.646	.688	33/64
032	32	.667	.708	33/64
033	33	.688	.729	33/64
034	34	.708	.750	33/64
035	35	.729	.771	33/64
036	36	.750	.792	33/64
037	37	.771	.813	33/64
038	38	.792	.833	33/64
039	39	.813	.854	33/64
040	40	.833	.875	33/64
042	42	.875	.917	33/64
044	44	.917	.958	33/64
045	45	.938	.979	33/64
046	46	.958	1.000	33/64
048	48	1.000	1.042	5/8
050	50	1.042	1.083	5/8
052	52	1.083	1.125	5/8

No. of Teeth Code	No. of Teeth	P.D.	O.D.	C Hub Dia.
054	54	1.125	1.167	5/8
055	55	1.146	1.188	5/8
056	56	1.167	1.208	5/8
058	58	1.208	1.250	5/8
060	60	1.250	1.292	5/8
064	64	1.333	1.375	5/8
066	66	1.375	1.417	5/8
068	68	1.417	1.458	5/8
072	72	1.500	1.542	3/4
075	75	1.563	1.604	3/4
080	80	1.667	1.708	3/4
084	84	1.750	1.792	3/4
090	90	1.875	1.917	3/4
092	92	1.917	1.958	3/4
096	96	2.000	2.042	3/4
100	100	2.083	2.125	3/4
108	108	2.250	2.292	3/4
110	110	2.292	2.333	3/4
120	120	2.500	2.542	3/4
130	130	2.708	2.750	3/4